

STEP 6

Open the app.
Add New Device.



STEP 7

Push the Scan button at the lower corner. When you see the controller appear in the list, push CONNECT.

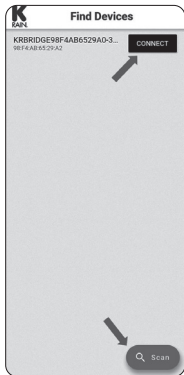

STEP 8

If the smart device is already connected to the preferred WiFi, the SSID will automatically populate. If not, you can either manually enter the SSID or push the Scan WiFi button to select the appropriate network. Then enter the network password and push CONNECT WiFi.



STEP 9

Press Register to Cloud. Then confirm by pushing CONTINUE. Then press OK on the message that says you are connected successfully.

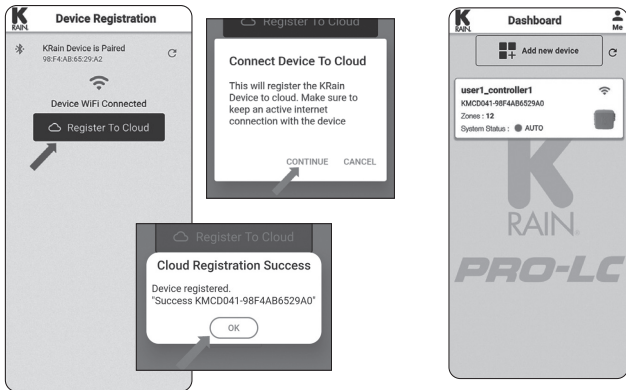

STEP 10

This will then take you to the dashboard to show you all your connected devices.

K RAIN | **PRO-LC**
WiFi-Ready Irrigation Controller



PRO-LC WiFi Controller

BRIDGE WiFi
Module



K-Rain Manufacturing Corp.
1640 Australian Avenue
Riviera Beach, FL 33404 USA
561.844.1002 | FAX: 561.842.9493
1.800.735.7246 | www.krain.com